



Alpha-335P grinding and polishing machine

Provide Comprehensive Metallographic Analysis Solutions

Product Introduction

Alpha-335P grinding and polishing machine is an automatic device used for rapid grinding and polishing of samples. This device is very suitable for laboratories or workplaces that perform testing on large samples or large quantities of samples. Accurate and reliable grinding and polishing ensure the repeatability of the samples and improve the preparation efficiency of the samples.

This equipment is suitable for grinding and polishing large samples using a 180mm diameter sample fixture seat on a grinding disc with a maximum diameter of 350mm/14 inch. The adjustable diamond suspension and lubricant addition system optimizes the distribution effect, improves the polishing quality of the samples, and the multi specification preparation method database ensures consistent reproducibility of the samples. The intuitive operation interface can display the status of the machine in real time, and the reasonable protective device maximizes the safety of the operators.



Component

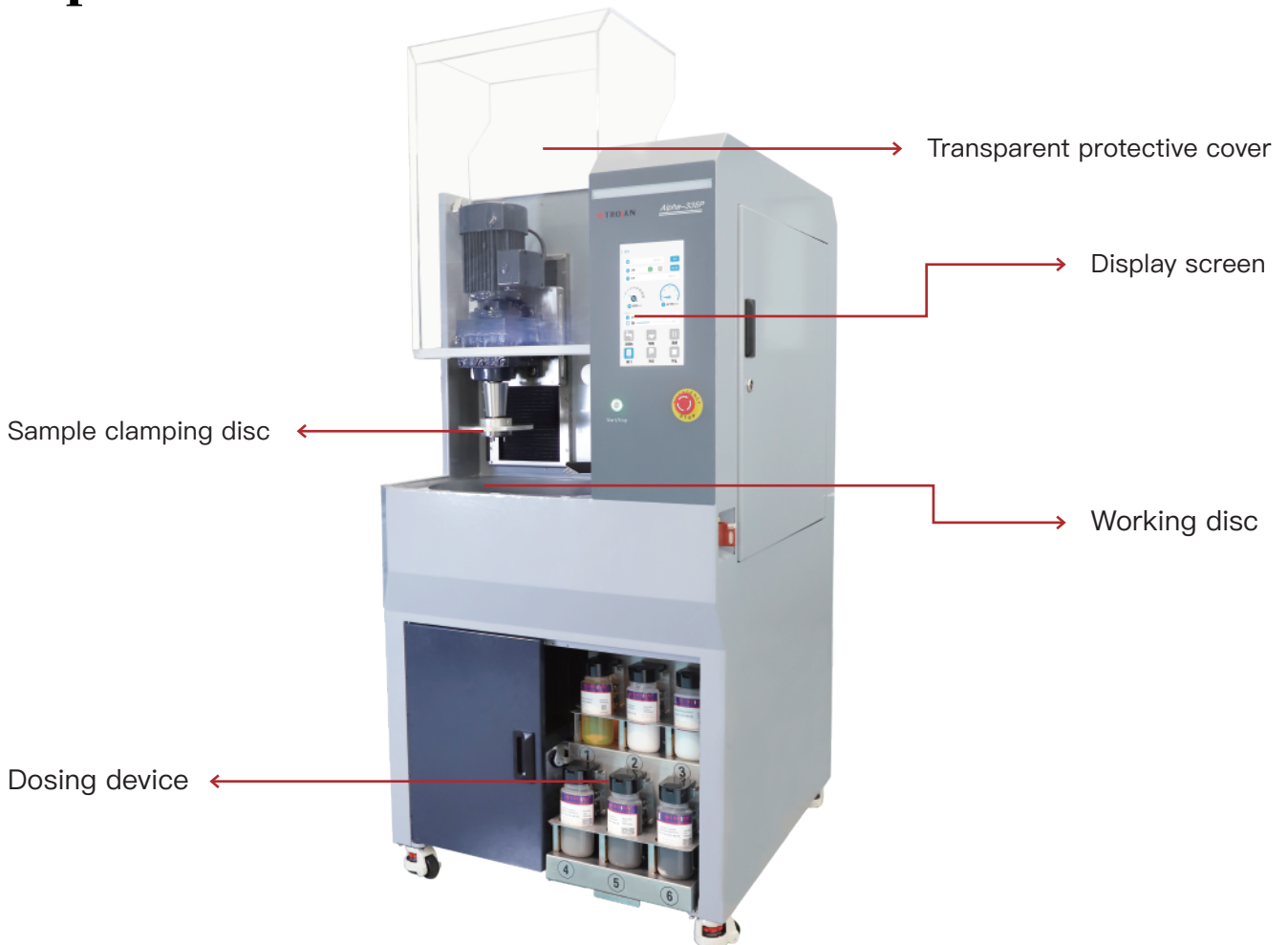

Main technical parameters

Working disc	Diameter	300 or 350mm
	Rotational speed	10–600rpm
	Rotation direction	Counterclockwise
	Motor power (S1)	2.2kw
Sample holder	Sample holder diameter	160mm
	Maximum height of the sample	40mm
	Loading Force	50–700N
	Rotational speed	10–125rpm
	Rotation direction	Clockwise/counterclockwise
	Motor power	0.37kw
	Torque	19NM
	Offset distance	0–80mm
Dosing system	Quantity	6 sets
	Flow rate	0.1–35ml/min
	Volume	500ml
	Mixing+high flow rate	3 sets
	Liquid level detection	Available
	Pump tube cleaning	Available
Operating environment	Ambient temperature	5–40°C
	Humidity	<85% relative humidity, no condensation
Power Supply	Voltage	3x380V+1PE+1N
	Rated power	3kw
Water supply	Water pressure	<0.3Mpa
Water tank [optional]	Volume	60L
	Flow rate	45L/min
	Filter accuracy	200 mesh
Air supply	Air pressure	0.6–0.8Mpa
	Maximum gas consumption	20Lmp
Exhaust [optional]	Air volume	180m ³ /h
	Power	0.18kw
Dimension [Cover closed]	WxDxH	80x90x165cm
Weight		485kg

Product Features

● Sample clamping and grinding system

1.The sample holder and clamping head are positioned by ball bearings, and the pin spring is reset to achieve stable clamping of the sample holder. The installation operation is simple and convenient;

2.The work disc adopts a soft positioning card sleeve structure, which can be easily disassembled.

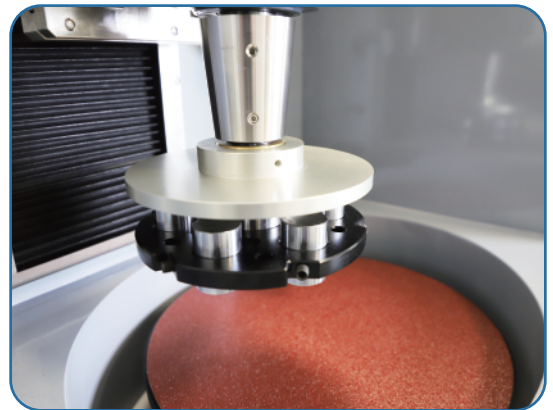

● Display system

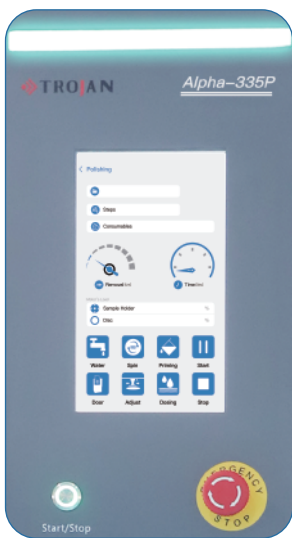

1.Simple operation interface, easy to operate on the machine after simple training;

2.Three color light warning prompt, easy to find faults and save maintenance time.

● Dosing device



Equipped with six sets of liquid addition pump devices and three sets of electromagnetic stirring functions to prevent suspension sedimentation. The optimal distribution of suspension and lubricant is achieved through the liquid addition nozzle to achieve the best grinding state.

● Operating system

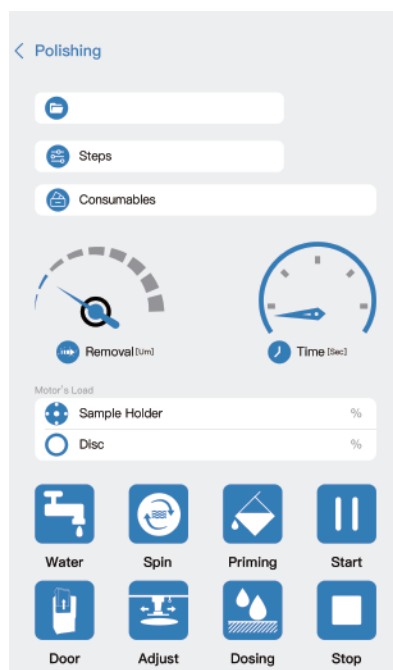

1.10-inch LCD touch screen panel, real-time display of current program dynamics on the LCD screen, simple and easy to understand, convenient and fast operation settings;

2. Customize the program library to save and call program methods at any time, with simple and convenient operation.

● Working disc

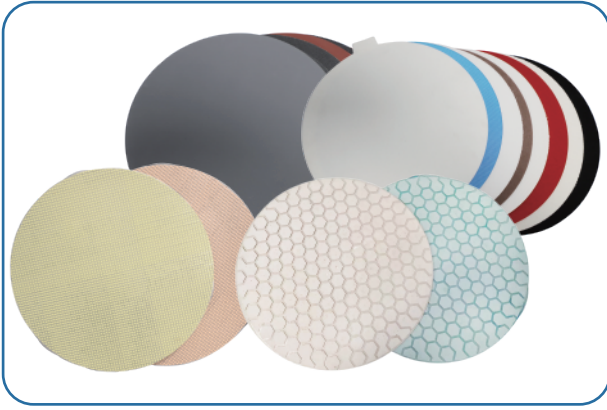

Provide grinding and polishing discs with different specifications to meet the sample preparation needs of different materials.

Equipment dimension diagram

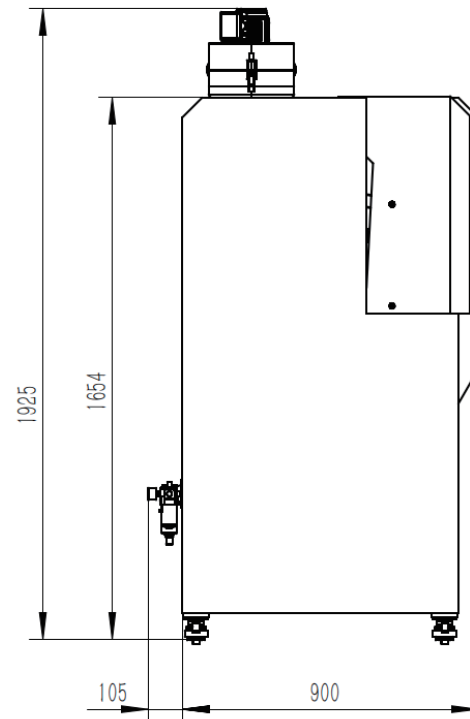
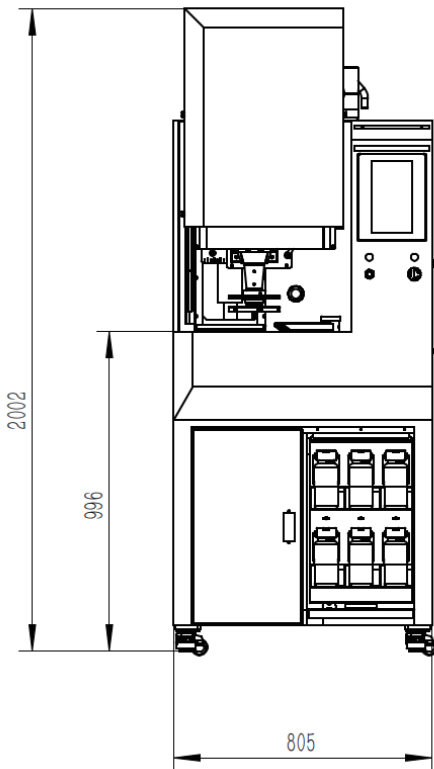

Accessories

Various standard sample clamping discs and accessories are available for selection.

1. Workpiece clamping tool (sample clamping disc)



25 Tear
Drop Fixture



32 Tear
Drop Fixture



40 Tear
Drop Fixture



50 Tear
Drop Fixture



Find a flat plate



Universal
leveling device



Trojan (Suzhou) Material Technology Co.,Ltd

Tel: +86 -512-65283666

Email: sales@trojanchina.com

Web: www.trojanchina.com

Add: Building 26, No. 228 Gongtang Road, Luzhi Town, Wuzhong Suzhou, China

